

1 Bed Semi-Detached In Lilliput Court , Chipping Sodbury, Bristol, BS37 6EB

£129,000





SHORT DESCRIPTION

Property Ref: 13572 Charming One-Bedroom Semi-Detached Home in Chipping Sodbury Welcome to Lilliput Court, a delightful one-bedroom semi-detached home nestled in the heart of Chipping Sodbury, Bristol. Perfectly positioned in a tranquil and well-established neighborhood, this charming property offers a cozy living experience ideal for first-time buyers, downsizers, or those seeking a peaceful retreat. Key Features: One Spacious Bedroom: A well-proportioned bedroom providing a peaceful haven, complete with ample natural light and space for storage. Modern Bathroom: A sleek and contemporary bathroom featuring quality fixtures and fittings, offering a comfortable space to unwind. Inviting Living Room: The generous living room is perfect for relaxation and entertaining, boasting a warm ambiance and a layout that maximizes space. Prime Location: Situated at Lilliput Court, this home benefits from the charm of Chipping Sodbury, with its blend of historic appeal and modern conveniences. The property is within easy reach of local shops, cafes, and transport links, ensuring you're well-connected to both Bristol and surrounding areas. Whether you're stepping onto the property ladder or looking for a cozy, low-maintenance home, Lilliput Court offers the perfect blend of comfort, convenience, and character.



Bed Room(s)



Bath Room(s)



Living Room(s)

FLOOR PLAN

Illustrations are for identification purposes only and are not to scale.
All measurements are a maximum and include wardrobes and bay windows where applicable.

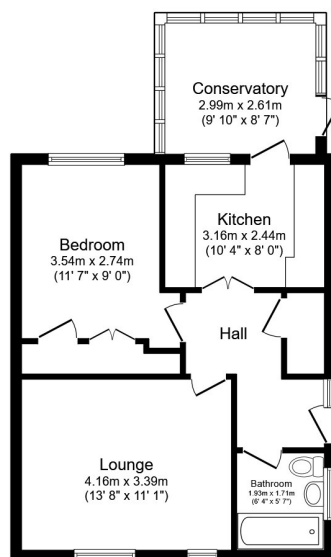

Total floor area 54.2 sq.m. (584 sq.ft.) approx

This floor plan is for illustrative purposes only. It is not drawn to scale. Any measurements, floor areas (including any total floor area), openings and orientation are approximate. No details are guaranteed, they cannot be relied upon for any purpose and they do not form part of any agreement. No liability is taken for any error, omission or misstatement. A party must rely upon its own inspection(s). Powered by www.focalagent.com

EPC GRAPH

Illustrations are for identification purposes only and are not to scale.
All measurements are a maximum and include wardrobes and bay windows where applicable.

Score	Energy rating	Current	Potential
92+	A		
81-91	B		86 B
69-80	C		
55-68	D		
39-54	E	44 E	
21-38	F		
1-20	G		

Disclaimer: The information displayed about this property comprises a property advertisement. 99home.co.uk (/) will not make no warranty for the accuracy or completeness of the advertisement or any linked or associated information, and 99home has no control over the content. This property advertisement does not constitute property particulars, the property may offer to tenants in same condition as they have seen on time of the viewing. The information is provided and maintained by 99home.co.uk (/)

Company registration number in England : 10469887 VAT: 263 3023 36
Copyright © 99Home Limited 2017. All rights reserved.