

3 Bed Detached Bungalow In Beechwood Avenue Chatham, Chatham, ME5  
7HJ

£599,995





## SHORT DESCRIPTION

Property Ref: 13532 We are pleased to offer the sale of this spacious 3 detached bungalow Featuring Double glazed & central heating 3 Bedrooms Kitchen/breakfast room Large lounge Popular location on Darland Banks Close proximity to shop, schools and transport links EPC E39 Council tax band F Chatham has great links to London and the Continent via a mainline train station and M2 motorway DISCLAIMER To the best of our knowledge, the information contained is accurate. Whilst we take reasonable care to ensure its accuracy, we cannot guarantee this and do not supply any warranty or representation of any kind in relation to the content. We reserve the right to change the information at any time. We cannot accept any responsibility for any loss, damages arising from these details..

3

Bed Room(s)

1

Bath Room(s)

1

Living Room(s)

## FLOOR PLAN

Illustrations are for identification purposes only and are not to scale.  
All measurements are a maximum and include wardrobes and bay windows where applicable.

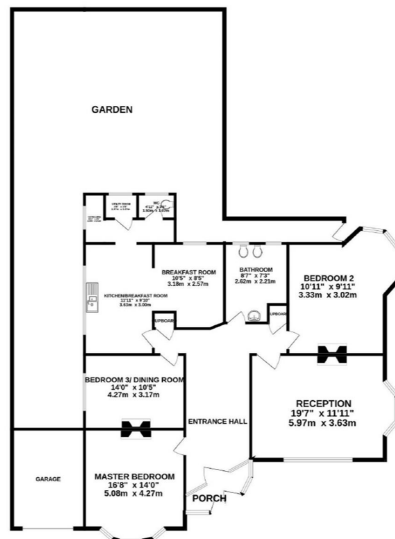

This floorplan is for illustrative purpose only

All sizes are approximate and there is no guarantee to the accuracy of the drawing or sizes

**DISCLAIMER**  
To the best of our knowledge, the information contained is accurate. Whilst we take reasonable care to ensure its accuracy, we cannot guarantee this and do not supply any warranty or representation of any kind in relation to the content. We reserve the right to change the information at any time.

## EPC GRAPH

Illustrations are for identification purposes only and are not to scale.  
All measurements are a maximum and include wardrobes and bay windows where applicable.

## Energy rating and score

This property's energy rating is E. It has the potential to be D.

[See how to improve this property's energy efficiency.](#)

| Score | Energy rating | Current | Potential |
|-------|---------------|---------|-----------|
| 92+   | A             |         |           |
| 81-91 | B             |         |           |
| 69-80 | C             |         |           |
| 55-68 | D             |         | 65 D      |
| 39-54 | E             | 39 E    |           |
| 21-38 | F             |         |           |
| 1-20  | G             |         |           |

The graph shows this property's current and potential energy rating.

Properties get a rating from **A (best)** to **G (worst)** and a score. The better the rating and score, the lower your energy bills are likely to be.

For properties in England and Wales:

the average energy rating is D  
the average energy score is 60

**Disclaimer:** The information displayed about this property comprises a property advertisement. 99home.co.uk (/) will not make no warranty for the accuracy or completeness of the advertisement or any linked or associated information, and 99home has no control over the content. This property advertisement does not constitute property particulars, the property may offer to tenants in same condition as they have seen on time of the viewing. The information is provided and maintained by 99home.co.uk (/)

Company registration number in England : 10469887 VAT: 263 3023 36  
Copyright © 99Home Limited 2017. All rights reserved.