

2 Bed Flat In Woolsack Close , Tetbury, GL8 8FW

£57,500





SHORT DESCRIPTION

Property Ref: 13432 Council tax:B Woolsack Close, Tetbury, GL8 8FW Welcome to this charming coach house property situated in the picturesque town of Tetbury. Nestled in the serene and sought-after area of Woolsack Close, this delightful residence offers a perfect blend of comfort and convenience. As you enter, you'll be greeted by a spacious open-plan living area that seamlessly combines the living, dining, and kitchen spaces. The modern design and thoughtful layout provide an inviting atmosphere, ideal for both relaxation and entertaining. This lovely home boasts two well-appointed bedrooms, offering ample space for rest and rejuvenation. The property also features a stylishly designed bathroom, ensuring comfort and functionality for everyday living. Adding to the appeal, this property includes two dedicated car parking spaces, providing the utmost convenience for you and your guests. Located in the heart of Tetbury, Woolsack Close offers easy access to local amenities, shops, and dining options, making it an ideal choice for those seeking a tranquil yet connected lifestyle. Don't miss the opportunity to make this wonderful coach house your new home. Contact us today to arrange a viewing!!.



Bed Room(s)



Bath Room(s)



Living Room(s)

FLOOR PLAN

Illustrations are for identification purposes only and are not to scale.
All measurements are a maximum and include wardrobes and bay windows where applicable.

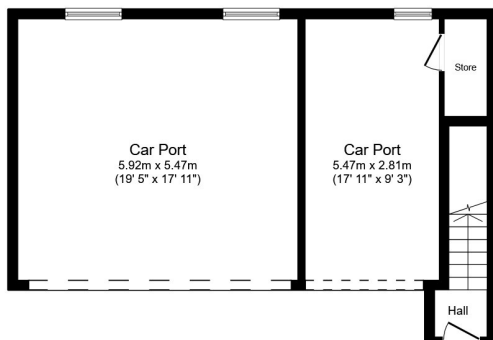

Ground Floor

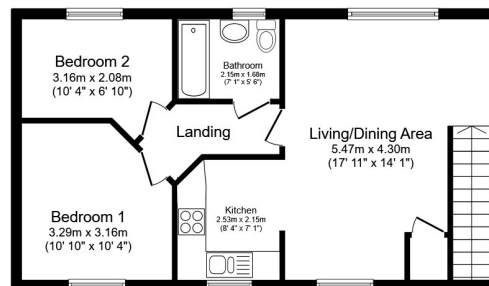

First Floor

Total floor area 59.6 m² (641 sq.ft.) approx

This floor plan is for illustrative purposes only. It is not drawn to scale. Any measurements, floor areas (including any total floor area), openings and orientation are approximate. No details are guaranteed, they cannot be relied upon for any purpose and they do not form part of any agreement. No liability is taken for any error, omission or misstatement. A party must rely upon its own inspection(s). Powered by www.focalagent.com

EPC GRAPH

Illustrations are for identification purposes only and are not to scale.
All measurements are a maximum and include wardrobes and bay windows where applicable.

Score	Energy rating	Current	Potential
92+	A		
81-91	B	81 B	81 B
69-80	C		
55-68	D		
39-54	E		
21-38	F		
1-20	G		

Disclaimer: The information displayed about this property comprises a property advertisement. 99home.co.uk (/) will not make no warranty for the accuracy or completeness of the advertisement or any linked or associated information, and 99home has no control over the content. This property advertisement does not constitute property particulars, the property may offer to tenants in same condition as they have seen on time of the viewing. The information is provided and maintained by 99home.co.uk (/)

Company registration number in England : 10469887 VAT: 263 3023 36
Copyright © 99Home Limited 2017. All rights reserved.