

2 Bed Terraced In Chevenham Close , Colwall, Malvern, WR13 6RG £69,000





SHORT DESCRIPTION

Property Ref: 13157 Welcome to Chevenham Close, a delightful two-bedroom home nestled in the picturesque village of Colwall, Malvern. This inviting property offers a perfect blend of comfort and convenience, ideal for first-time buyers, small families, or those looking to downsize. Key Features: Two Cozy Bedrooms: Enjoy the comfort of two well-proportioned bedrooms, each providing a peaceful retreat at the end of the day. These rooms are perfect for creating your personal oasis, whether it's a cozy guest room, a child's room, or a home office. Modern Bathroom: The home features a sleek and contemporary bathroom, complete with modern fixtures and fittings. It's designed to offer a serene space for relaxation with a stylish yet functional layout. Inviting Living Room: The spacious living room serves as the heart of the home, ideal for both relaxing and entertaining. With ample natural light streaming through the windows, this room exudes a warm and welcoming atmosphere. Well-Equipped Kitchen: Adjacent to the living area, the kitchen is thoughtfully designed with ample storage and counter space, making meal preparation a pleasure. Whether you're a seasoned cook or just enjoy occasional baking, this kitchen caters to all your culinary needs. Private Garden: Step outside to discover a charming garden, perfect for outdoor dining, gardening, or simply unwinding in the fresh air. This private outdoor space enhances the overall appeal of the property, providing a serene spot to enjoy nature. Convenient Location: Situated in the sought-after area of Colwall, this home offers easy access to local amenities, including shops, schools, and transport links. The beautiful Malvern Hills are just a short distance away, offering stunning scenery and numerous outdoor activities. Parking: The property also includes convenient parking, ensuring you always have a space for your vehicle. Experience the charm and comfort of this lovely two-bedroom home at Chevenham Close. With its desirable location and well-designed interiors, it's ready to welcome its new owners. Don't miss the opportunity to make this delightful house your new home.

2

Bed Room(s)

1

Bath Room(s)

1

Living Room(s)

FLOOR PLAN

Illustrations are for identification purposes only and are not to scale.
All measurements are a maximum and include wardrobes and bay windows where applicable.

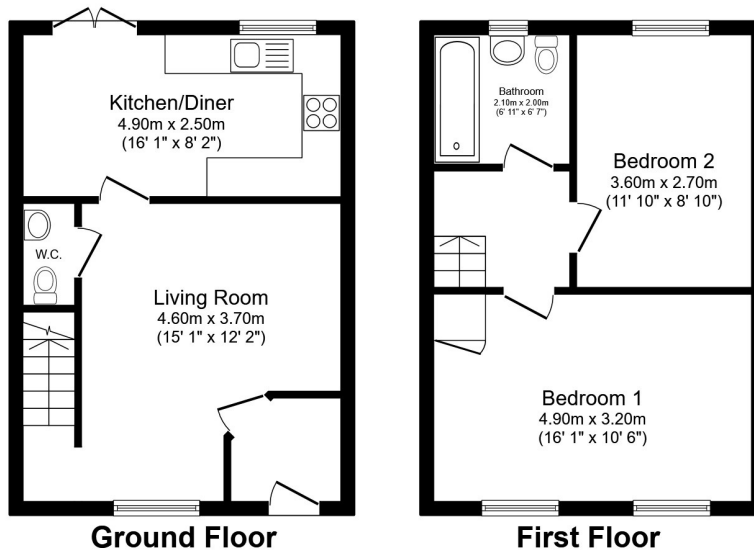

Total floor area 70.6 m² (760 sq.ft.) approx

This floor plan is for illustrative purposes only. It is not drawn to scale. Any measurements, floor areas (including any total floor area), openings and orientation are approximate. No details are guaranteed, they cannot be relied upon for any purpose and they do not form part of any agreement. No liability is taken for any error, omission or misstatement. A party must rely upon its own inspection(s). Powered by www.focalagent.com

EPC GRAPH

Illustrations are for identification purposes only and are not to scale.
All measurements are a maximum and include wardrobes and bay windows where applicable.

Energy rating and score

This property's energy rating is B. It has the potential to be A.

[See how to improve this property's energy efficiency.](#)

Score	Energy rating	Current	Potential
92+	A		97 A
81-91	B	83 B	
69-80	C		
55-68	D		
39-54	E		
21-38	F		
1-20	G		

The graph shows this property's current and potential energy rating.

Properties get a rating from A (best) to G (worst) and a score. The better the rating and score, the lower your energy bills are likely to be.

For properties in England and Wales:

- the average energy rating is D
- the average energy score is 60

Disclaimer: The information displayed about this property comprises a property advertisement. 99home.co.uk (/) will not make no warranty for the accuracy or completeness of the advertisement or any linked or associated information, and 99home has no control over the content. This property advertisement does not constitute property particulars, the property may offer to tenants in same condition as they have seen on time of the viewing. The information is provided and maintained by 99home.co.uk (/)

